



ROTARY CONTROL VALVE | CAMFLEX® II 35002 | ECCENTRIC PLUG

Size: DN25 to DN100 (1" to 4") | **Body Pressure Rating:** ANSI 600 as per B16.34 standard

End Connections: Flangeless clamps between | **Flow Direction:** Flow to Open or Flow to Close

Body Material: Carbon Steel / Stainless Steel | **Trim Material:** Solid Stellite No.6



- Heavy duty guide lugs assure quick, positive alignment during installation
- Straight through flow pattern provides **greater flow capacities**.
- Standard integral extension bonnet allows for a **wide range of fluid temperature application** (-196°C to 400°C).
- The unique self-aligning eccentric rotating plug provides **tight shut off** and **low dynamic forces**.
- A large variety of reduced trim options available in all sizes.
- Powerful, low profile spring diaphragm actuator guarantees positive "fail safe" action.
- Differential Velocity Device (DVD) can be fitted into control valve for aerodynamic noise reduction of up to 18 dB

Temperature / Seat Leakage:

Valve Size		Seat Type	Temp Range (°C)		Seat Leakage Class
in	DN		Min	Max	
1- 4	25-100	Metal	-196	400	IV
		Soft Seat	-196	232	VI

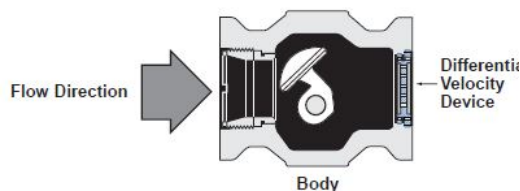

Application:

Boiler feed water control, pressure control, level control, temperature control and flow control for process plants from edible oil refinery, palm oil mills, pulp & paper and petrochemical.

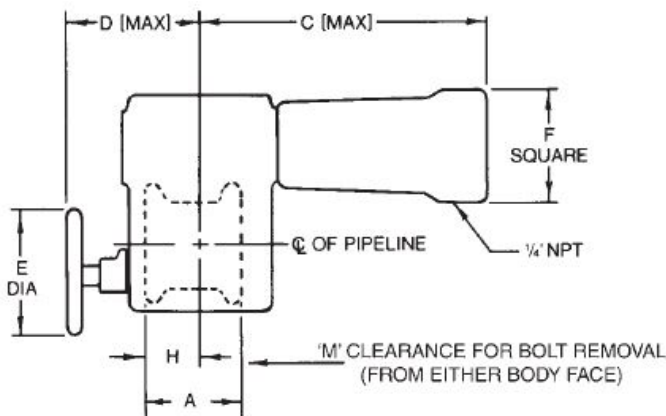
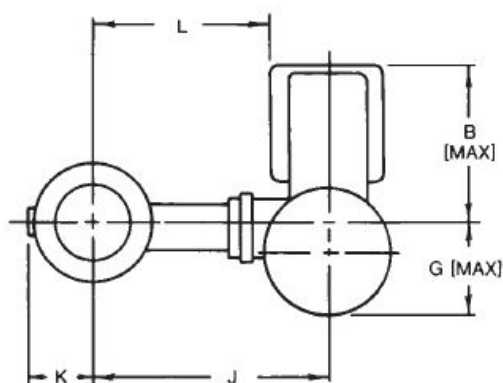

Dimensions in mm for flangeless body design

Size	A	B	C	D	E	F	G	H	J	K	L	Weight (kg)
25	102	173	293	253	160	140	112	62	206	38	137	17
40	114	175	293	253	160	140	113	62	234	51	165	19
50	124	176	293	253	160	140	115	62	239	66	170	20
80	165	262	426	266	160	175	130	97	333	84	244	46
100	194	264	426	266	160	175	131	106	356	109	267	54